

RWC5353BE060-500

PHYSICAL DIMENSIONS:

A	53.00	±	0.50
B	53.00	±	0.50
C	37.00		TYP.
D	10.00	±	2.00
E	10.00		TYP.
F	6.00		MAX.
G	43.00	±	1.00
H	20.50	±	1.00
I	2.50	±	0.40

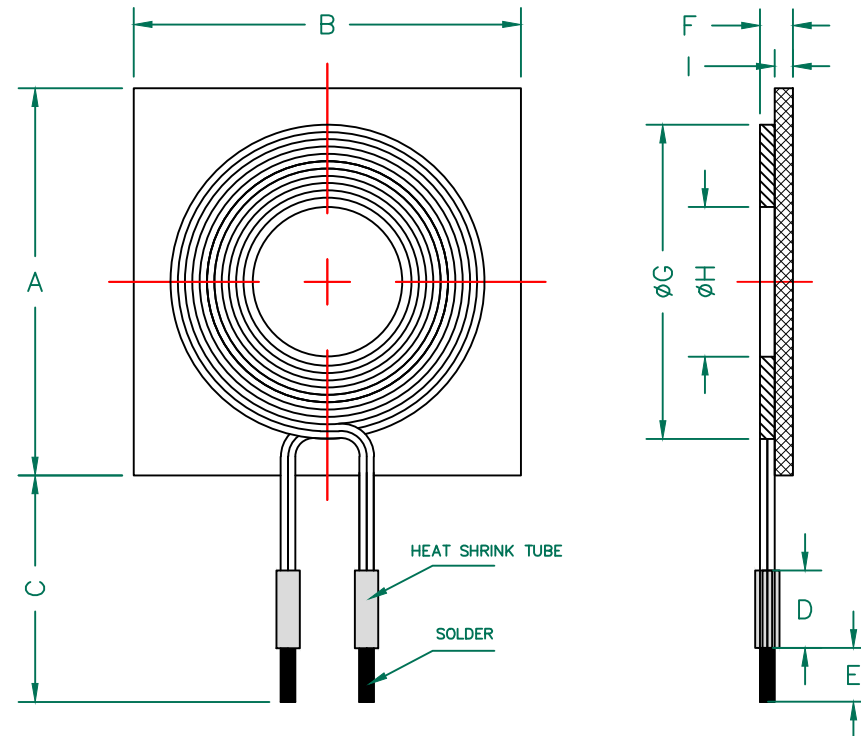

ELECTRICAL SPECIFICATION @ 25°C

	Min	Nom	Max
INDUCTANCE (uH) L @ 125KHz/1V ±10%	5.67	6.30	6.93
DCR (mΩ)			25
Q @ 125KHz/1V		120	

NOTES: UNLESS OTHERWISE SPECIFIED

1. OPERATING TEMPERATURE RANGE: -40°C TO +125°C (INCLUDING SELF-HEATING) .
2. STORAGE TEMPERATURE RANGE (PACKAGING CONDITIONS): -10°C TO +40°C AND RH 70% (MAX.)
3. UNLESS OTHERWISE SPECIFIED, THE STANDARD ATMOSPHERIC CONDITIONS FOR MEASUREMENT/TEST AS:
 - A. AMBIENT TEMPERATURE: 20±15°C.
 - B. RELATIVE HUMIDITY: 65%±20%.
4. RATED CURRENT: 3A.



DIMENSIONS ARE IN mm.				This print is the property of Laird Tech. and is loaned in confidence subject to return upon request and with the understanding that no copies shall be made without the written consent of Laird Tech. All rights to design or invention are reserved.			
				PROJECT/PART NUMBER:	REV	PART TYPE:	DRAWN BY:
				RWC5353BE060-500	A		QIU
				DATE:	SCALE:	NTS	SHEET:
				11/30/15			
				CAD #	TOOL #		
				RWC5353BE060-500-A	-		
A	NEW RELEASE	11/30/15	QIU	1 of 1			
REV	DESCRIPTION	DATE	INT				