

PHYSICAL DIMENSIONS:

A	48.00	±	0.50
B	48.00	±	0.50
C	46.50		Max.
D	46.50		Max.
E	15.00		Min.
F	5.00	±	2.00
G	1.00		Max.
H	5.00		Ref.

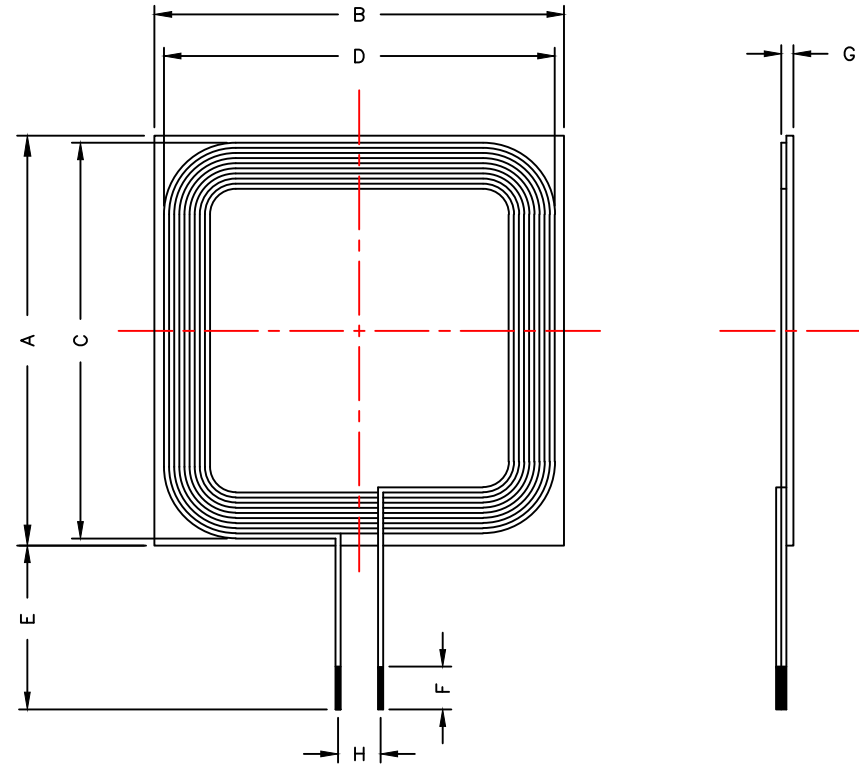

ELECTRICAL SPECIFICATION @ 25°C

	Min	Nom	Max
INDUCTANCE (uH) L @ 100KHz/0.5V ±10%	9.00	10.00	11.00
DCR (mΩ)			180
RATED CURRENT (A)	2		

NOTES:

1. OPERATION TEMPERATURE RANGE:
-40°C~+85°C (INCLUDING SELF-HEATING).
2. G IS MEASURED AFTER REMOVING LINER OF ADHESIVE
3. RATED CURRENT IS DC CURRENT THAT CAUSES THE TEMPERATURE RISE($\Delta T \leq 10^\circ C$) FROM 20°C AMBIENT.



DIMENSIONS ARE IN mm.				This print is the property of Laird Tech. and is loaned in confidence subject to return upon request and with the understanding that no copies shall be made without the written consent of Laird Tech. All rights to design or invention are reserved.		Laird		
				PROJECT/PART NUMBER:		REV	PART TYPE:	DRAWN BY:
				SWC4848KA100-600		A		QIU
				DATE:		SCALE:		MATERIAL:
				07/26/16		1 : 1		
A	ORIGINAL DRAFT	07/26/16	QIU	CAD #		TOOL #		
REV	DESCRIPTION	DATE	INT	SWC4848KA100-600-A				