

| 8                        | 7                      | 6                  | 5                           |
|--------------------------|------------------------|--------------------|-----------------------------|
| BASE PART NUMBER         | THICKNESS              | MATERIAL           | STANDARD LENGTH PART NUMBER |
| 0097-0913<br>(STANDARD)  | 0.096 ± 0.005 [0.0038] | BeCu ALLOY 25 TH01 | 0097091302                  |
| 0098-0913<br>(ULTRASOFT) | 0.051 ± 0.005 [0.0020] | BeCu ALLOY 25 TH01 | 0098091302                  |

| PLATING CODE TABLE  |               |
|---|---------------|
| NUMBER CODE   | PLATING TYPE  |
| 02  | BRIGHT FINISH |
| 17  | BRIGHT TIN    |
| 19  | BRIGHT NICKEL |
| MORE PLATING OPTIONS AVAILABLE<br>CONTACT LAIRD SALES FOR DETAILS |               |

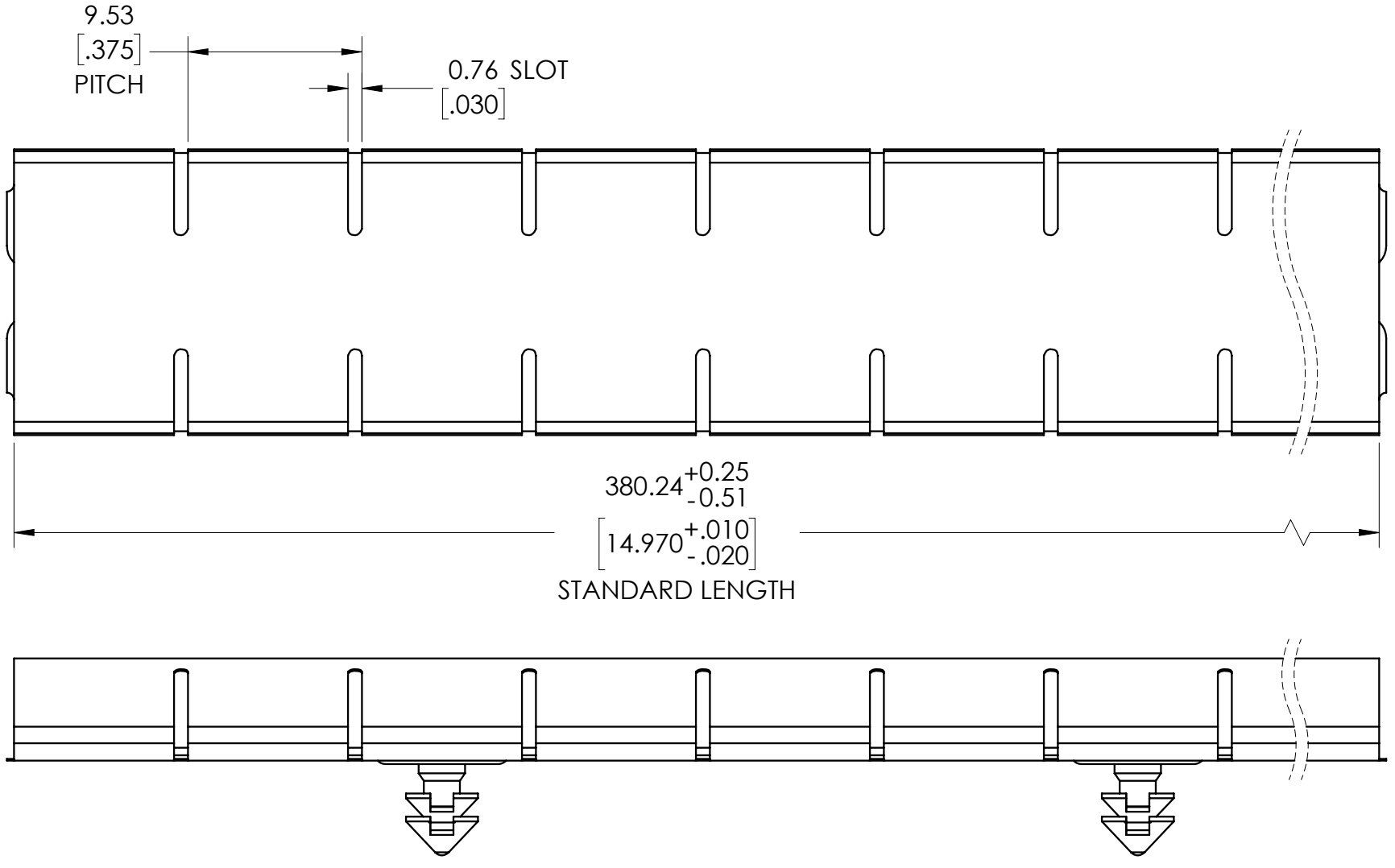

CUSTOM LENGTHS AVAILABLE IN MULTIPLES OF PITCHES OR "FINGERS"  
 LENGTH = PITCH X N  
 WHERE 'PITCH' IS 9.53 AND 'N' IS NUMBER OF PITCHES  
 EXAMPLE: 21 x 9.53 = 200.13MM LONG  
 SEE BOTTOM LEFT FOR CUSTOM LENGTH PART NUMBERING

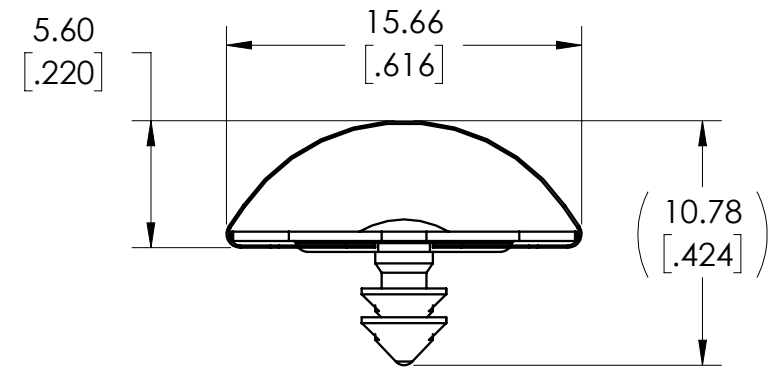

CUSTOM LENGTH PART NUMBER CONFIGURATION:  
 009X 0913 XX N OXXXX

7 FOR STANDARD  
8 FOR ULTRASOFT

PLATING CODE  
(SEE TABLE)

LENGTH IN MM TO  
ONE DECIMAL PLACE

EXAMPLE: 0098091317N02001  
 ULTRASOFT, BRIGHT TIN PLATING, 200.13MM LONG (21 FINGERS)

|   |  |  |
|---|--|--|
| UNITS: MM [INCH]  | <b>Laird</b>   | LAIRD DRAWING NUMBER:<br><b>0097-0913-SALES</b>  |
| TOLERANCES:<br>X.X = ± 0.4<br>X.XX = ± 0.2<br>X.XXX = ± 0.1 |  | THIS IS AN UNCONTROLLED SALES DRAWING. THE DIMENSIONAL CHARACTERISTICS AND TOLERANCES OF THIS PART SHOWN ON THIS DRAWING AS A REFERENCE TO THE DIMENSIONAL SPECIFICATIONS OF THE LAIRD STANDARD PRODUCTION DRAWING FOR THIS PART. ANY SUBSEQUENT CHANGES TO THE STANDARD PART SPECIFICATION WILL SUPERSEDE THIS SALES DRAWING. |
| ANGULAR:<br>X° = ± 3°<br>X.X° = ± 1.0°                      | 3RD ANGLE PROJECTION<br>DESIGNED IN SOLIDWORKS<br>SCALE: 3:1 | SIZE <b>B</b><br>SHEET 1 OF 1  |